

FEATURES & BENEFITS

ACTIVATION

Sanitary activation for enhanced hygienic hydration in public places where pushing a valve button is not recommended.

SENSOR

Mechanical valve is replaced by infrared sensor technology for reliable operation.

TOUCHLESS OPERATION

Touchless electric sensor allows for hands-free operation with a simple front motion, eliminating the need for manual activation.

INSTALLATION

Easy to follow instructions provides quick in-field installation to change a fountain or bottle filler to sensor operation.

SYSTEM CERTIFIED

System is certified to NSF61 and the California health and safety code 116875 (ab 1953)

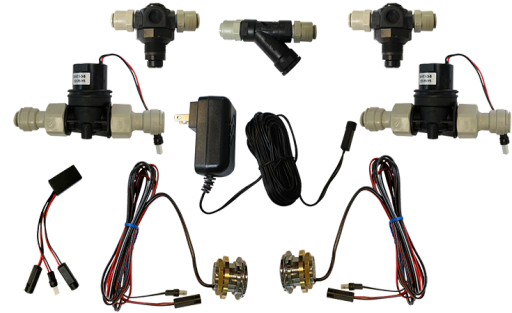

SPECIFICATIONS

The Haws 2RKHO.H sensor retrofit kit includes electric solenoid valves controlled by sensors that will convert most Haws standard push button operated wall-mounted dual station drinking fountains, or a single fountain-1920 bottle filler combination to be a touchless system which allows these products to be operated hands-free. Each kit contains touchless, motion activated sensors that activate stainless steel solenoid valves to start the flow of water, valve regulators to control the amount of water delivered to the fountain or bottle filler, and a plug-in transformer (mounted inside a wall, away from water).

APPLICATIONS

Specifically, this kit will work with Haws models: 1011, 1011HPS, 1011HPSMS, 1011MS, 1117L, 1117LN, 1119, 1119.14, 1409, 1430, 1431, 1441, 1501, H1011.8, H1011.8HPS, H1117.8 and H1119.8. This kit can also be used with the single fountain-1920 bottle filler combination models (not intended for freeze-resistant models).

For more information, visit www.hawsc.com or call (888) 640-4297.

NOTES:

- 2RKHOP AND 2RKHOH RETROFIT KITS ALLOW THE FOLLOWING INDOOR FOUNTAINS TO BE CONVERTED FROM A HAWS 587/4 PUSH BUTTON VALVE TO HANDS-OFF (TOUCHLESS) OPERATION:
 1001, 1001HPS, 1001HPSMS, 1001MS, 1011, 1011HPS, 1011HPSMS, 1011MS, 1025, 1025G, 1047
 1105, 1107L, 1109, 1109.14, 1117L, 1117LN, 1119, 1119.14
 H1001.8, H1001.8HPS, H1011.8, H1011.8HO, H1011.8HPS, H1107.8, H1109.8, H1117.8, H1119.8
 1920, 1920HPS, 1920V
 1311, 1409, 1430, 1431, 1435, 1441, 1501
- FOUNTAINS (NOT SUPPLIED) MAY BE MOUNTED ON THE EXTERNAL WALL OF A BUILDING PROVIDED THE TRANSFORMER SHALL BE MOUNTED INSIDE THE WALL AND PROTECTED FROM WATER AS SHOWN IN THIS INSTALLATION PER NEC/CEC AND LOCAL CODE.
- RETROFIT KIT MODEL:
 2RKHOP: INDOOR HO RETRO-FIT KIT (INCLUDES 2X HO SENSOR WITH MOUNTING HARDWARE, 2X SOLENOID VALVE, 2X REGULATOR, SPLITTER, AND 100-240V PLUG-IN TRANSFORMER - SEE SHEET 2).
 2RKHOH: INDOOR HO RETRO-FIT KIT (INCLUDES 2X HO SENSOR WITH MOUNTING HARDWARE, 2X SOLENOID VALVE, 2X REGULATOR, SPLITTER, AND 100-277V HARDWIRE TRANSFORMER - SEE SHEET 3).
 2RKHOP REQUIRES 100-240VAC POWER CONNECTION. 2RKHOH REQUIRES 100-277V POWER CONNECTION.
- TRANSFORMERS MUST BE MOUNTED SUCH THAT THEY ARE PROTECTED FROM WATER.
- 2RKHOP TRANSFORMER IS COMPATIBLE WITH TYPE A AND TYPE B NORTH AMERICAN ELECTRICAL OUTLETS. FOR OTHER RECEPTACLE TYPES, AN ADAPTER (NOT SUPPLIED) MUST BE PROVIDED BY OTHERS.

(NOTES CONTINUED ON SHEET 4)

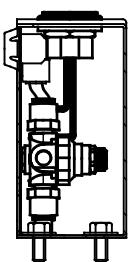

EXAMPLE 1920 BOTTLE FILLER INSTALLATION

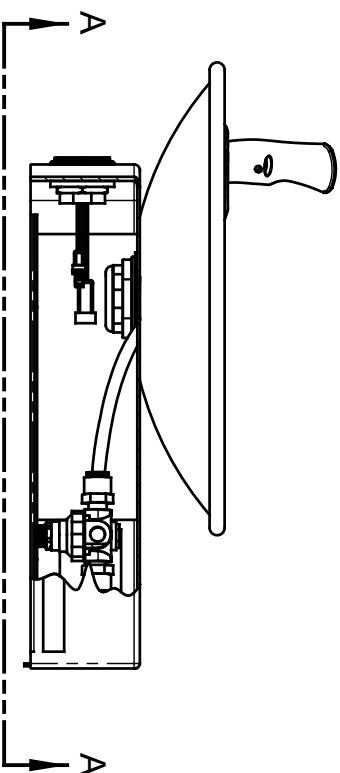

EXAMPLE 1011 FOUNTAIN INSTALLATION

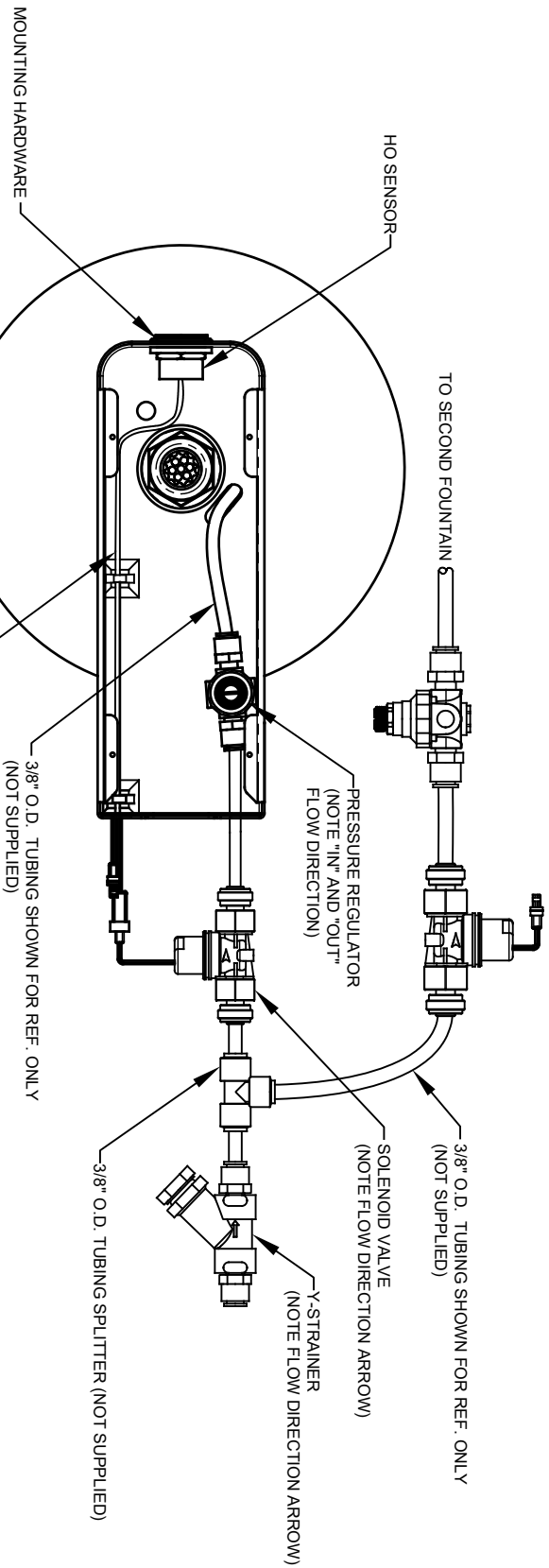

(BOTTOM PLATE OMITTED FOR CLARITY)

VIEW A - A

POWER CONNECTION HARNESS (SEE ELECTRICAL SCHEMATIC - SUPPLIED WITH TRANSFORMER KIT - SHOWN FOR REFERENCE)

		HAWS	
1456 KLEPPE LANE SPARKS, NEVADA, 89431 (775) 359-4712 FAX (775) 359-7424 E-MAIL: HAWS@HAWSCO.COM WEBSITE: WWW.HAWSCO.COM		MODEL(S) 2RKHOP / 2RKHOH DUAL HANDS-OFF RETRO-FIT KIT	
ECN NO. REVISED PERBY: 5849	ECN: 5705	BLM	BLM
DATE: 02/10/21	CHKD: EV	APPROVED: DP	DATE: 06/15/21
SCALE: N/A	DRAWING TYPE: INSTALLATION	SIZE: A	SHEET: 1 OF 4
PART NUMBER 0580001156.D		REVISION 3	

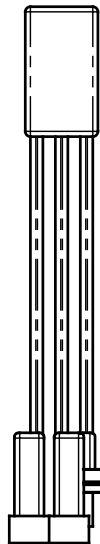

DUAL POWER SPLITTER

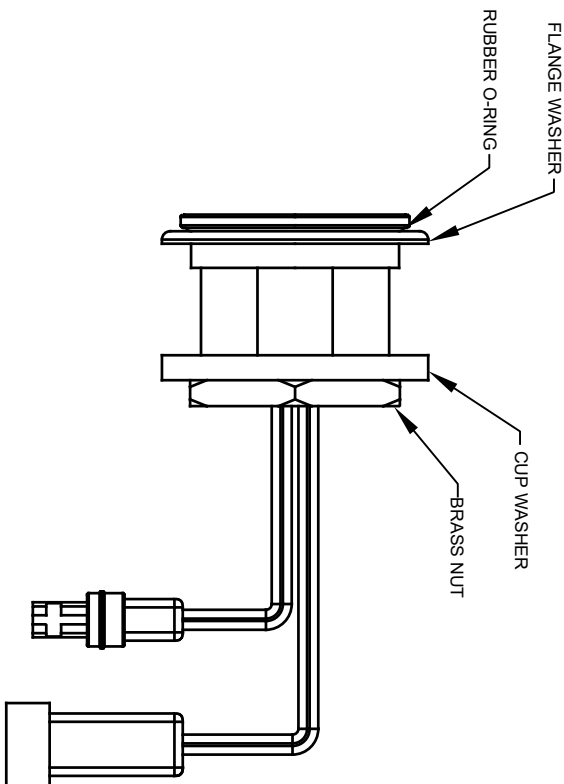

HO SENSOR ASSEMBLY (2X)

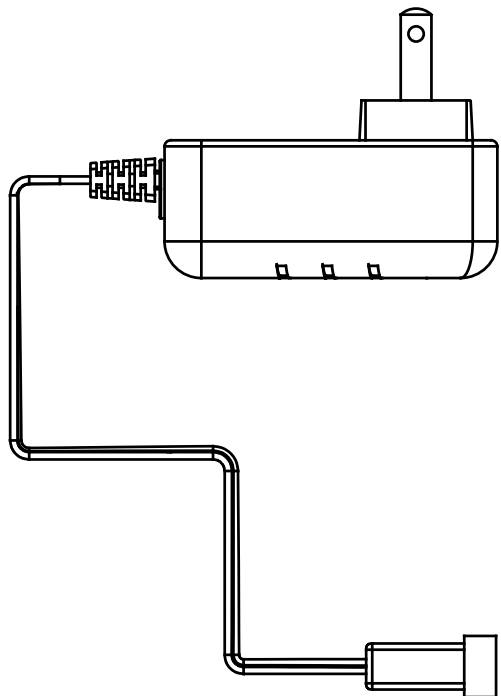

PLUG-IN TRANSFORMER

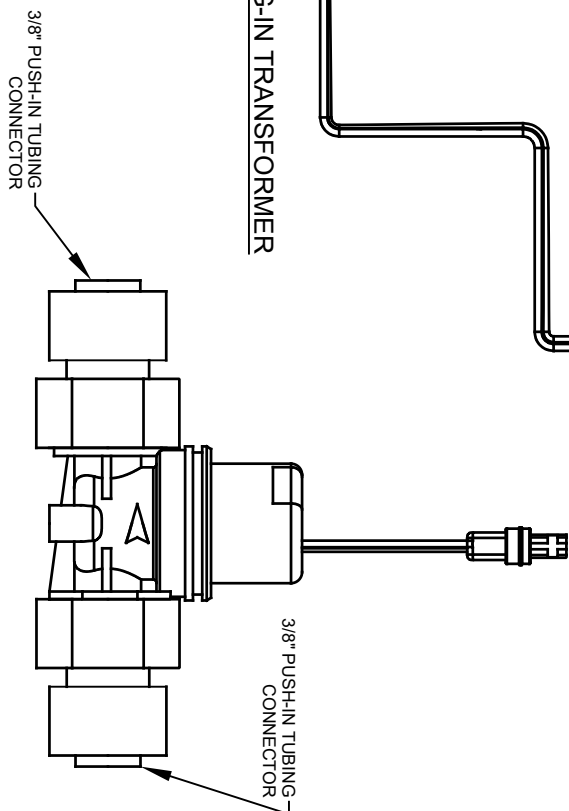

SOLENOID VALVE ASSEMBLY (2X)

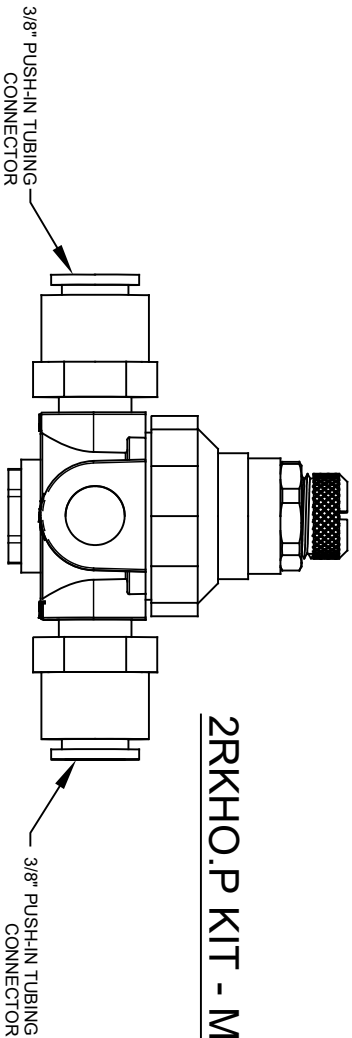

VALVE REGULATOR (2X)

2RKHO.P KIT - MAIN PARTS

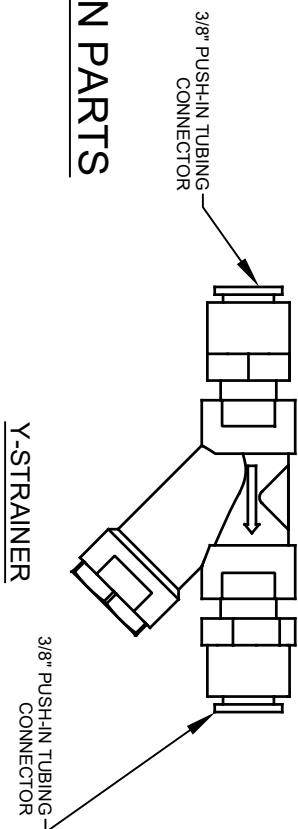

Y-STRAINER

		Haws	
1459 KLEPPE LANE SPARKS, NEVADA 89431 (775) 359-4712 FAX (775) 359-7424 E-MAIL: HAWS@HAWS.CO.COM WEBSITE: WWW.HAWS.CO.COM			
ECN NO. REVISED PERBY:	MODEL(S)	PART NUMBER	
5849	2RKHO.P / 2RKHO.H	0580001156.D	
DATE: 02/10/21	DATE: 02/10/21	REVISION:	3
CHKD: FV	CHKD: FV	REVISION:	3
DATE: 06/15/21	SCALE: N/A	DRAWING TYPE:	INSTALLATION
APPROVED: DP	SCALE: N/A	DRAWING TYPE:	INSTALLATION
DUAL HANDS-OFF RETRO-FIT KIT		SIZE: A SHEET: 2 OF 4	

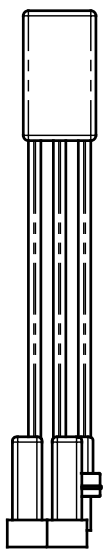

DUAL POWER SPLITTER

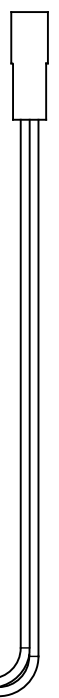

HARDWARE TRANSFORMER

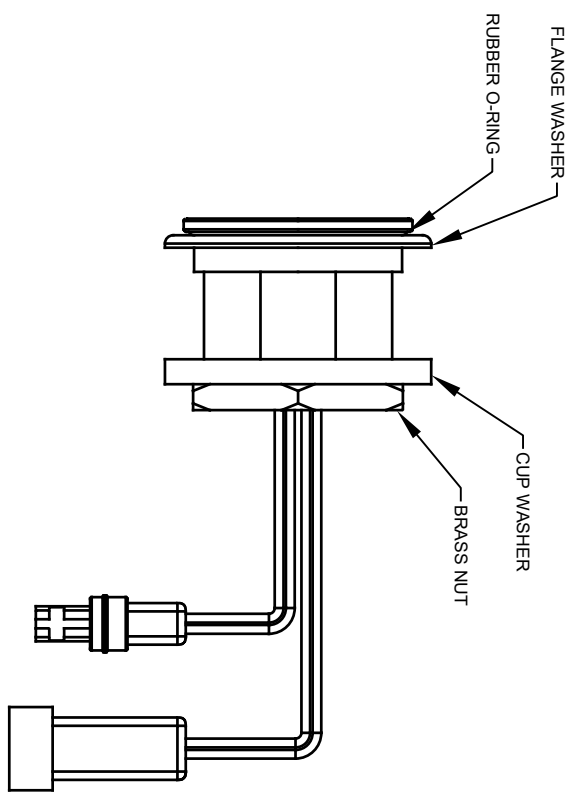

HO SENSOR ASSEMBLY (2X)

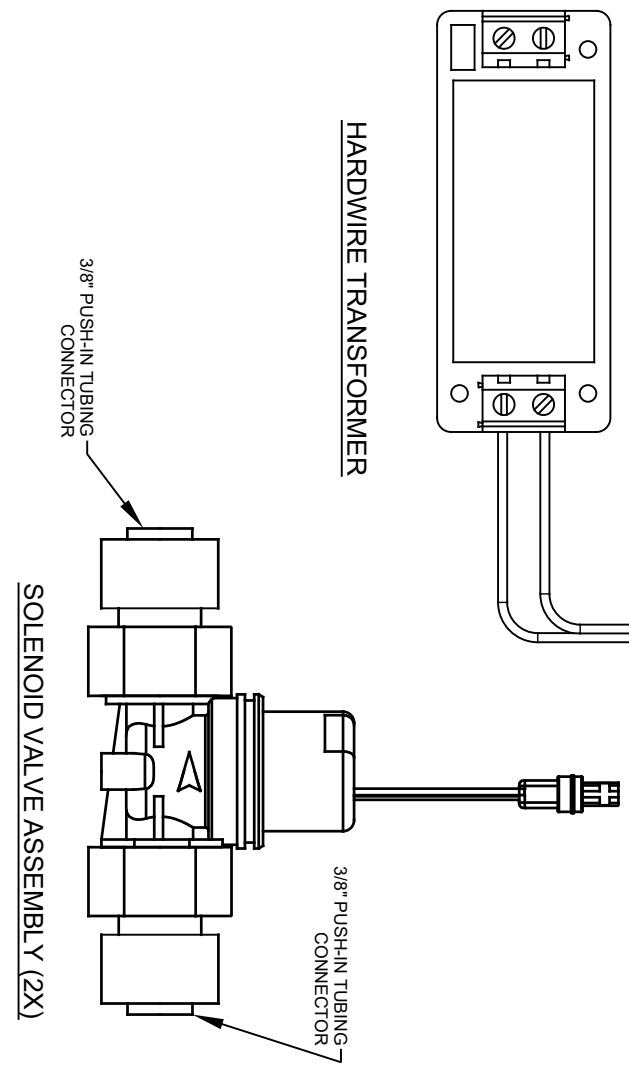

SOLENOID VALVE ASSEMBLY (2X)

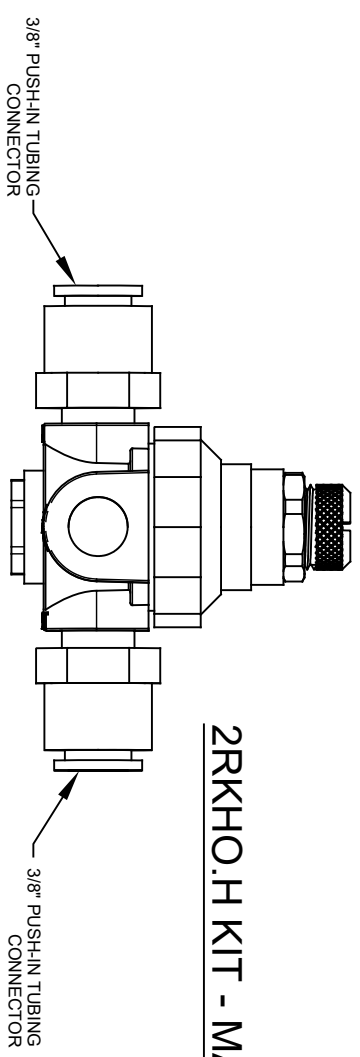

VALVE REGULATOR (2X)

2RKHO.H KIT - MAIN PARTS

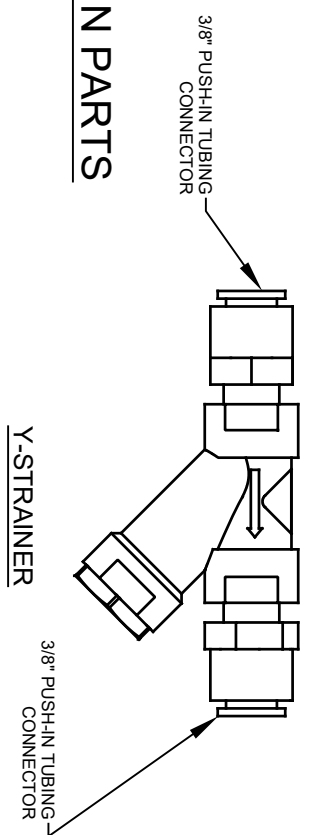

Y-STRAINER



Haws

1456 KLEPPE LANE
SPARKS, NEVADA 89431
(775) 359-4712 FAX (775) 359-7424
E-MAIL: HAWS@HAWS.CO.COM
WEBSITE: WWW.HAWS.CO.COM

ECN NO. REVISED PER BY:	MODEL(S)	PART NUMBER
5849	2RKHO.P / 2RKHO.H	0580001156.D
DATE: 02/10/21	DRAWING TYPE	REVISION
02/10/21	DUAL HANDS-OFF RETRO-FIT KIT	3
DATE: 06/15/21	INSTALLATION	SHEET 3 OF 4
SCALE: N/A	DRAWING TYPE	
APPROVED: DP		

NOTES (CONTINUED FROM SHEET 1):

- 6. 2RKHO.H TRANSFORMER WIRE RANGE: 24-12 AWG
2RKHO.H TRANSFORMER TIGHTENING TORQUE: MAX 0.4 N*m

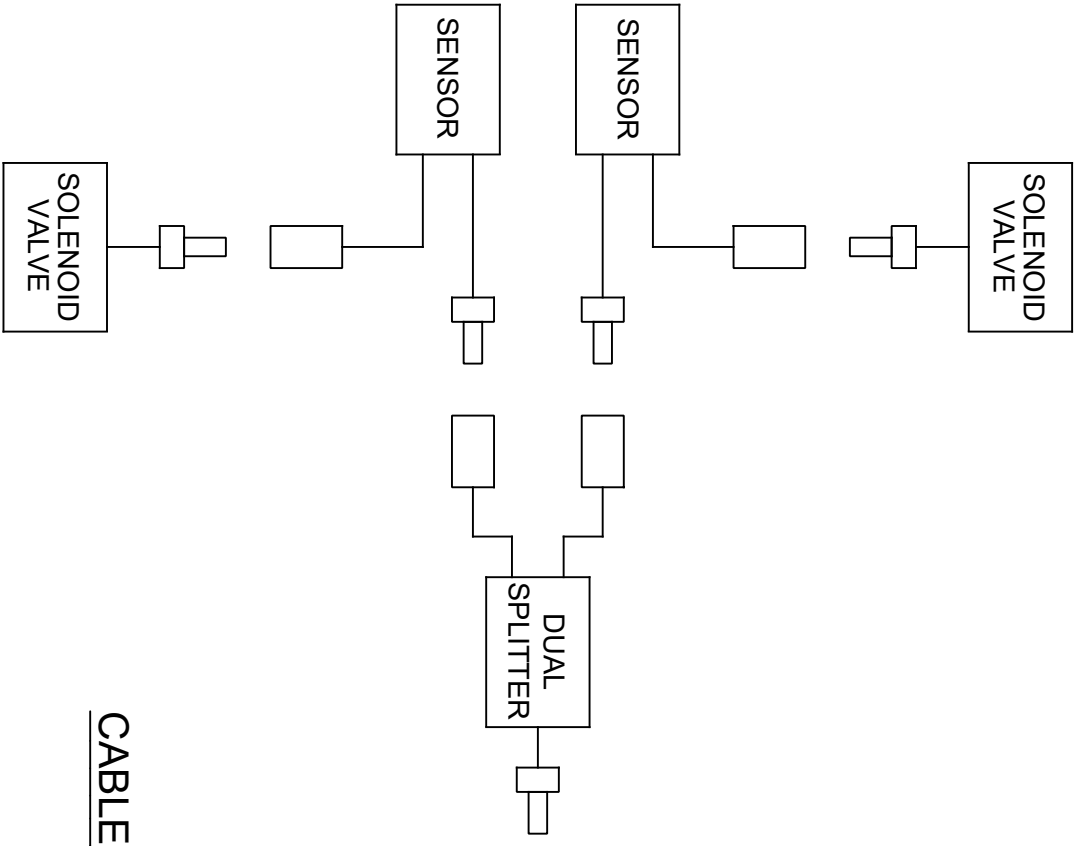

2RKHO.H TRANSFORMER

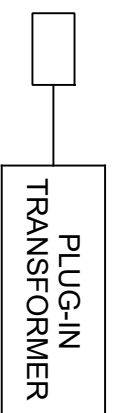

2RKHO.P TRANSFORMER

CABLE WIRING SCHEMATIC

		1459 KLEPPE LANE	
SPARKS, NEVADA, 89431		(775) 359-4712 FAX (775) 359-7424	
E-MAIL: HAWS@HAWS.CO.COM		WEBSITE: WWW.HAWS.CO.COM	
ECN NO. REVISED PER BY:	MODEL(S)	PART NUMBER	
5849	2RKHO.P / 2RKHO.H	0580001156.D	
DATE: 02/10/21	DATE: 02/10/21	REVISION:	3
CHKD: EV	CHKD: EV		
APPROVED: DP	SCALE: N/A	DRAWING TYPE: INSTALLATION	SIZE: A SHEET 4 OF 4